

KENTUCKY DERBY WEEK 2024 – HORSEMEN INFORMATION
SATURDAY, APRIL 27 – SATURDAY, MAY 4, 2024

Backside Entry

Entry Points & Times

- Stable Gate entrance at 3716 Oakdale Avenue
 - o Open and staffed 24 hours
 - o Saturday, April 27: closed 7:00AM – 12:00PM due to KDF Mini Marathon
- Service Gate 11, located off Longfield Avenue for **walk-through admission**
 - o Saturday, April 27 – Thursday, May 2: 4:45AM – 10:30AM
- **Saturday, April 27 – MARATHON 7:00AM – 12:00PM**
 - o **Stable employees will be allowed to walk in via Service Gate 11. All vehicular traffic including horse trailers will use X Gate at the end of Longfield Avenue for entry.**

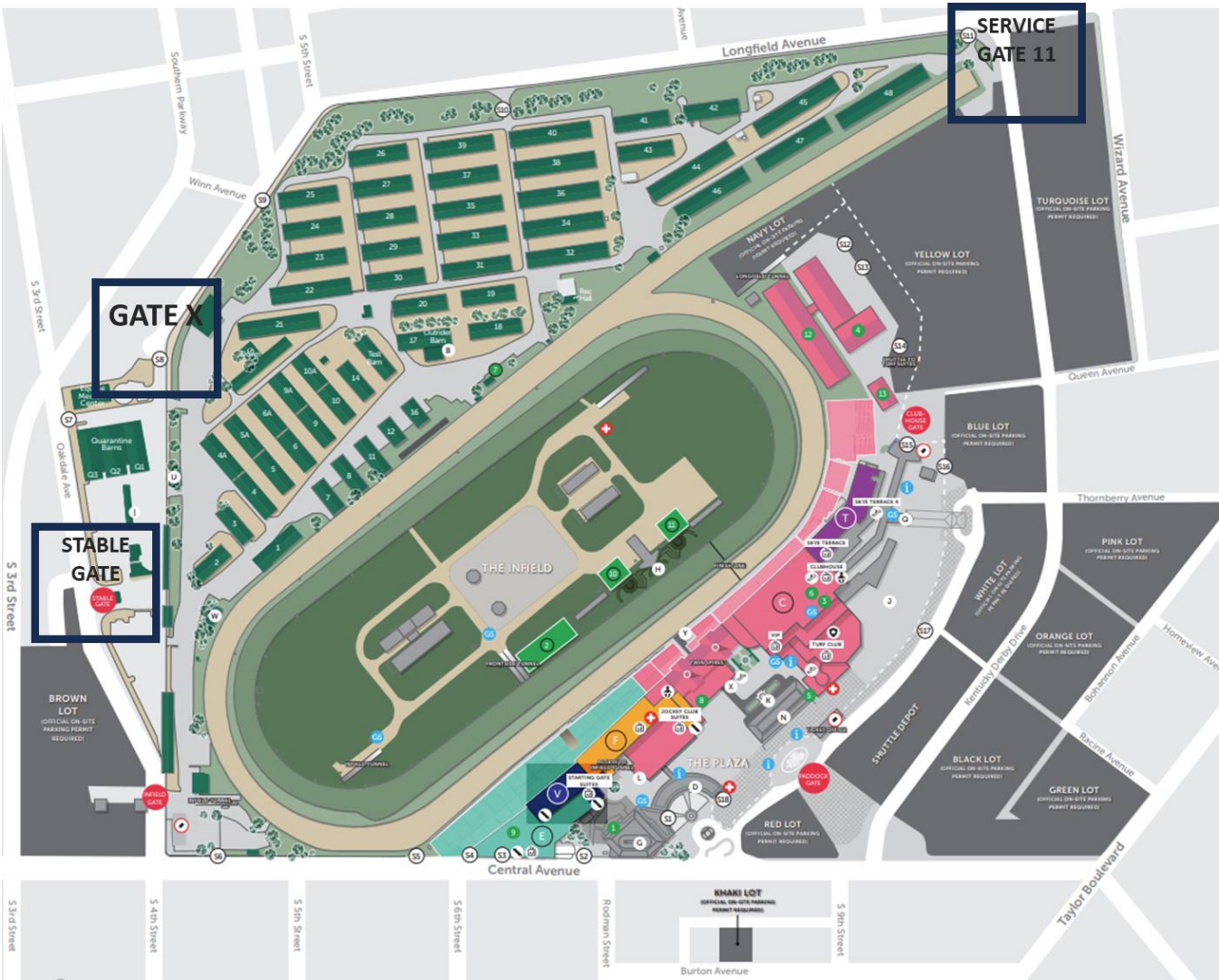

Vehicle Traffic and Parking

From Saturday, April 27 (Opening Night) through Saturday, May 4 (Derby Day), only vehicles with approved backside vehicle access passes issued by Churchill Downs will be granted entry into the Stable Gate. Trainers may pick up passes from Steve Hargrave in the Stable Gate office and may disseminate them to owners at their discretion. ALL VEHICLES WILL BE VISUALLY INSPECTED AT THE TIME OF ENTRY BY SECURITY.

Please note, no horsemen vehicles will be allowed through the frontside tunnel during training or live racing. Traffic control at the infield gate tunnel will be provided during morning training hours beginning April 27.

- The only passes allowed for entrance to the backside are the following:
 - o Vehicle Backside Access Pass
 - One pass per day will be issued. Pass is only valid for the day for which it was issued.
 - o Vendor Stable Yard Pass
 - Valid for use all week.
 - o Red Lot Parking Pass
 - Allows access to the barn areas
 - Jockeys, CDI Executives
 - o Horse vans with horses, feed trucks, hay/straw vendors
 - No feed trucks, hay, or straw delivery will be permitted on Oaks and Derby days.
- Oakdale Avenue will be closed:
 - o Saturday, April 27 – times of KDF Marathon 7:00AM – 12:00PM
 - o Thursday, May 2 beginning at 9:30AM
 - o Friday, May 3 (Oaks) beginning at 8:00AM
 - o Saturday, May 4 (Derby) beginning at 8:00AM
- NOTE: Vehicles entering with Vehicle Access Driving pass do NOT need to be scanned as they have been approved by Churchill Downs separately.

SATURDAY, APRIL 27 - KENTUCKY DERBY FESTIVAL MINI MARATHON

Kentucky Derby Festival Marathon will run through Churchill Downs. Central Avenue will be closed between 3rd Street and 9th Street, and Oakdale Avenue will be closed from Central Avenue from 7:00AM – 12:00PM. During this time, the **Stable Gate and Infield tunnel will be closed.** **Please use Service Gate 11 to enter and exit the backside for pedestrians. ALL VEHICULAR TRAFFIC INCLUDING HORSE TRAILERS MUST USE SERVICE GATE X.**

Horsemen Barcodes

- Each trainer will receive an individual barcode uniquely assigned to them. Each code will have unlimited scans throughout the week. If there is an issue at the gate, we will be able to determine which trainer to contact.
- The barcode will present as below on a mobile device.

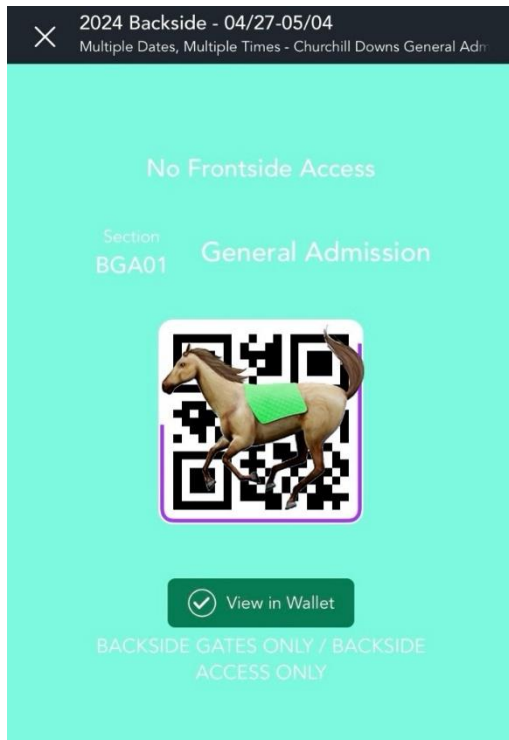

Walking Access Saturday, April 27 – Thursday, May 2 (Morning training)

- Owners and guests of horsemen may park in the Turquoise lot off Longfield Avenue and walk through Service Gate 11 to enter the barn area.
 - o Saturday, April 27 – Wednesday, May 1
 - All cars must be out of the Turquoise lot by 10:30AM or they will be towed at the expense of the owner.
 - o Thursday, May 2
 - All cars must be out of the Turquoise lot by 9:30AM or they will be towed at the expense of the owner.
- Guests MUST have a horsemen access barcode sent from their trainer for each person present. Barcodes will be scanned at time of entry, one scan per member of the group.
 - o If a guest arrives without a barcode, they will be directed to contact their trainer.
 - o If the situation must be escalated, please contact one of the following for approval of entry:
 - Bill Vest, Steve Hargrave, Gary Palmisano, Ben Huffman or Cathy Shircliff

PARKING AND STABLE ACCESS – SERVICE GATE 11



Walking Access Friday, May 3 (Oaks) – Saturday, May 4 (Derby)

- KHRC license holders or guests of horsemen may **walk** through the main Stable Gate (Oakdale Avenue) if they have a horsemen access barcode from their trainer. Note, there is no vehicle traffic on Oakdale after 8:00AM.
- Horsemen access barcodes will be scanned at the time of entry and each member of the group must have a barcode.

Golf Cart Access to Frontside April 27 – May 2

Horsemen golf carts will be permitted on the frontside, provided they follow CDRT staff instructions and are mindful of guests attending Dawn at the Downs. Horsemen may be stopped for visual cart inspection and/or hand wand screening if deemed necessary. Please place a placard or some sort of sign on your cart identifying the barn or trainer.

Access to the Racing Office

- From Saturday, April 27 – Wednesday, May 1, a KHRC license may be scanned at any available lane for gate entry.
- From Thursday, May 2 – Saturday, May 4, horsemen may ride the Horsemen Shuttle from the backside to the Clubhouse Gate during live racing. At the Clubhouse Gate, they may enter through the lane for ADA, CREDENTIALS, FAST PASS or via any guest lane.
- *Please note, the racing office is to the right of the Paddock, next to the Paddock Box Office and across from the Gift Shop.*
- ***Please only turn in silks needed for Derby week at this time.*

Access to Frontside on Oaks and Derby Day (May 3 – May 4)

- Only horsemen with Paddock Pass credentials for their specific race will be allowed onto the racetrack and access to the frontside.
- Undercard Owners: Paddock passes will be distributed directly to each trainer by Steve Hargrave for distribution to their owners and staff.
- Oaks and Derby: trainers will receive 6 paddock passes for trainer and staff use, to be picked up from Steve Hargrave. Owners will receive 18 paddock passes from their host.

Frontside Derby Week Parking Saturday, April 27 – Thursday, May 2 (Thurby)

- OWNERS: Reserved Frontside & Stable Area hang tags for owners will allow parking in the Turquoise Lot. Golf cart shuttle service will be provided to the Paddock Gate, where they will enter through the “ADA, Credentials, Fast Pass” lane or any available lane.
- On Thursday, May 2, Horsemen may use their hang tag to park in the Turquoise lot but are encouraged to park on the backside or Brown Lot and ride the Horsemen Shuttle from the backside to the Clubhouse Gate during live racing. At the Clubhouse Gate, they may enter through the “ADA, Credentials, Fast Pass” lane.
 - o Claiming or Saddling Parking
 - Horsemen with Frontside Reserved & Stable Area or Red Lot hang tags that are coming to claim or saddle in the Paddock may park in designated zones in the infield and walk through the frontside tunnel. Parking staff will be on hand to direct horsemen to appropriate parking. Any vehicle parked outside of assigned locations or impeding infield setup will be relocated at the owner’s expense.



Frontside Derby Week Parking Oaks – Derby

There is no frontside parking on Oaks and Derby day without a parking placard for a specific parking lot.

On Oaks and Derby, horsemen may ride the Horsemen Shuttle from the backside to the Clubhouse Gate during live racing. At the Clubhouse Gate, they may enter through the “ADA, Credentials, Fast Pass” lane.

Stable Shuttle

The Stable Shuttle runs from the backside to the frontside each morning and afternoon before and after racing for horsemen and media. Horsemen riding the shuttle will be searched before boarding via hand wands and a light bag search. See shuttle map provided for stops.

- Hours of Operation
 - Saturday, April 27: 4:00AM – 11:00AM, 11:00PM – 1:00AM
 - Sunday, April 28: 4:00AM – 11:00AM
 - Monday, April 29: 4:00AM – 11:00AM
 - Tuesday, April 30: 4:00AM – 11:00AM, 5:00PM – 8:00PM
 - Wednesday, May 1: 4:00AM – 10:30AM, 5:00PM – 8:00PM
 - Thursday, May 2 (Thurby): 4:00AM – 10:00AM, 7:30PM – 11:00PM
 - Friday, May 3 (Oaks): 4:00AM – 7:45AM, 10:00PM – 12:00AM
 - Saturday, May 4 (Derby): 4:00AM – 7:45AM, 10:00PM – 12:00AM

Horsemen Shuttle

HBPA-provided from the barn area to the Clubhouse gate. This shuttle will be labeled HORSEMEN SHUTTLE.

- Hours of Operation
 - Thursday, May 4: 10:30AM – 7:00PM
 - Friday, May 5 (Oaks): 9:00AM – 8:00PM
 - Saturday, May 6 (Derby): 9:00AM – 9:30PM

KENTUCKY DERBY SHUTTLE MAP

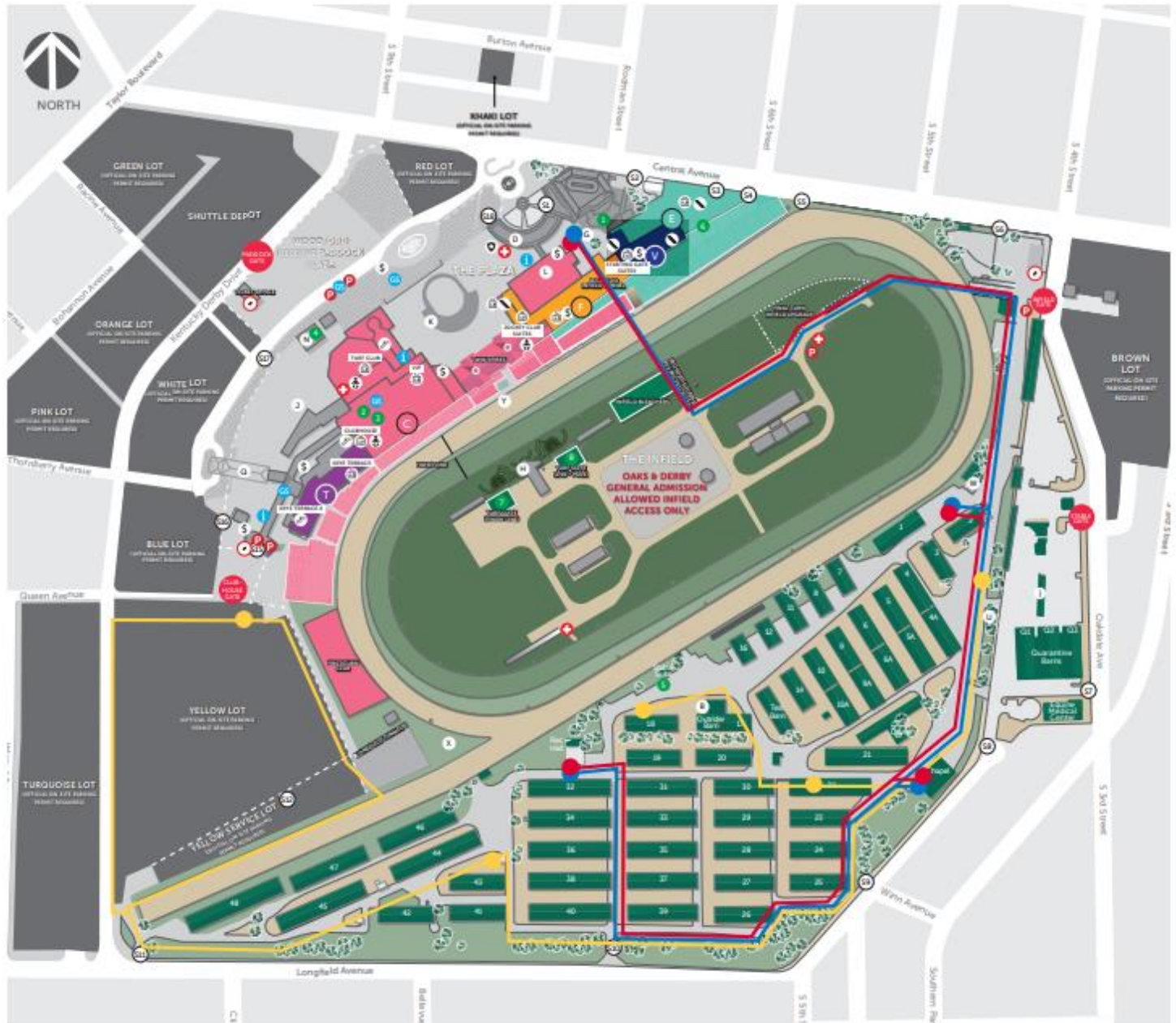

ICON LEGEND

- AM Stable Area Shuttle Route
- AM Stable Area Shuttle Stop
- PM Stable Area Shuttle Route
- PM Stable Area Shuttle Stop
- Horsemen Shuttle Route
- Horsemen Shuttle Stop

Access to the Stable Suite

The Stable Suite is a private hospitality location hosted by Keeneland and Lane's End between Gap 2 and 3, operating Monday, April 29 – Thursday, May 2 from 6:00AM – 10:00AM each day. This space is not managed by Churchill Downs Racetrack and access will be restricted to invited guests.

Paddock Schooling

Paddock schooling begins Monday, April 22 and is available every day with extended paddock schooling available as noted below.

- Monday, April 22 – Wednesday, May 1:
 - 10:00AM – 10:40AM
- Thursday, May 2 – Saturday, May 4:
 - No extended paddock schooling

Gate Schooling

- Saturday April 20 – Friday April 26:
 - 7:30AM – 9:30AM
- Saturday April 27 – Thursday May 2:
 - 7:30AM – 9:30AM
- Friday May 3 (Oaks):
 - 6:30AM – 7:30AM

Please note: No gate schooling at Churchill Downs or Trackside on Saturday, May 4 (Derby Day) through Monday, May 6.

Derby Week Ticketing

Opening Night (April 27) – Thurby (May 2)

- Every trainer or owner who enters a horse Opening Night (April 27) - Thurby (May 2) will be given 6 tickets. Undercard and Stakes accommodations vary by day, please contact Vicki Tomlinson for more ticketing information 502-636-4830 or Vicki.Tomlinson@kyderby.com
 - Trainers will be given 6 tickets per day that they have a horse entered, regardless of the number of horses entered.
 - Owners will be given 6 tickets per horse per day on days that they have horses entered.
- Your KHRC license may be used for General Admission for license holder + 1 guest, though on Thurby (May 2) access is restricted to the first floor only.

Oaks (May 3) and Derby (May 4)

On Oaks and Derby, all tickets are all inclusive of food, beverage and alcoholic beverage.

- TRAINERS
 - All trainers will be given one box per day that they have a horse entered, regardless of the number of horses entered. All trainers, including Oaks and Derby, contact Kelly Danner for ticketing 502-638-3825 or Kelly.Danner@kyderby.com or Madison Jackson 502-635-4616 or Madison.Jackson@kyderby.com.
 - Oaks and Derby Trainers will be given 2 VIP wristbands that will allow access throughout the facility (except the Spires Terrace & Suites, Turf Club Terrace, Private Suites, Matt Winn Steakhouse, The Mansion, the racetrack and the Paddock). The wristbands must be put on in the racing office and will be different for Oaks and Derby. Additionally, they will have the option to purchase 1 box of 6 tickets on the 3rd floor that come with tickets to the Ben A. Jones Lounge.
- OWNERS
 - Undercard Owners
 - Owners with a horse entered in any race other than the Oaks or Derby will receive a complimentary box, contact Kelly Danner 502-638-3825 or Kelly.Danner@kyderby.com
 - Oaks and Derby Owners
 - Owners with Oaks or Derby horses are given 18 tickets in a Winner's Circle Suite and have the option to purchase additional tickets. All Oaks or Derby owners, contact Chanda Day 502-636-4892 or Chanda.Day@kyderby.com

Miscellaneous Notes

- Only turn in Derby Week silks in advance of Derby Week.
- For the Oaks and Derby Walkover, during the gathering of the horses in the chute the horses will be put in numerical order. The horses MUST be in numerical order for the walkover.
- Frontside Tunnel Access
 - Traffic will be restricted to the frontside during hours when guests are on property from Opening Night (April 27) through Thurby (May 2) limited to:
 - Churchill Downs-branded vehicles
 - Heavy equipment (ie Fork Lifts)
 - Golf Carts with CDRT placards
 - Authorized vendor vehicles (*must have identification on side*).
 - Andy Frain will have a list of approved vendors with access through the frontside tunnel during racing.
- All horse trailers must be removed from Brown Lot by Thursday, May 2. If offsite parking is needed, please contact Steve Hargrave for information.
- *Please note: Media must display their Kentucky Derby Media Credential at all times and will be denied entry if they try to gain access without it.*

Additional information regarding Spring Meet starting Thursday, May 9 will be forthcoming.